

- CONSTRUCTION
- FLOW DIRECTION
- MOUNTING STYLE
- VISCOSITY RANGE
- HYDRAULIC MEDIUM
- OPERATING PRESSURE
- FLUID TEMPERATURE RANGE
- FLUID CLEANLINESS REQUIRAMENT
- NOMINAL FLOW HANDING CAPACITY
- CRACKING PRESSURE AVAILABLE IN
- LINE MOUNTING

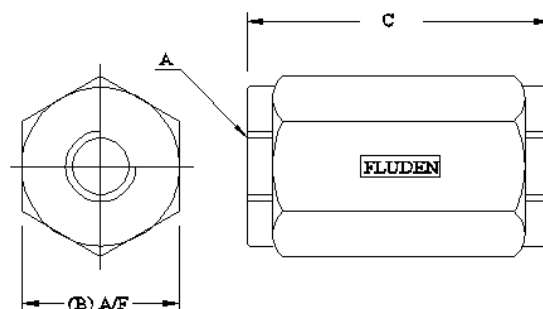

MODEL CODE	THREAD SIZE	MAX. FLOW L /MIN	CRACKING PRESSURE BAR	MAX. OPERATING PRESSURE BAR	B HEX	C LENGTH
C - 06 - T-01	1/4"	15		315	19	55
C - 08 - T-01	3/8"	35	1 = 0.5	315	24	61
C - 10 - T-01	1/2"	50		315	30	71
C - 15 - T-01	3/4"	120	3 = 3	315	36	86
C - 20 - T-01	1"	180		315	46	109
C - 25 - T-01	1 - 1/4"	280	5 = 5	315	60	114
C - 30 - T-01	1 - 1/2"	340		315	65	124

SEAT TYPE

Free low. From Port A to B leakage free closure in opposite direction in line mounting 10 cst to 380 cst mineral oil 315 bar -20 to - 70 degree C as per ISO Code 16/13 or better.

SIZE NG	FLOW (LPM)
6	10
10	20
16	30
20	120
30	280

SIZE NG	ROW (LPM)
6	0.1
10	0.31
16	0.63
20	0.95
30	2.3

TOLANRCE= + 1 MM

DIMENSION IN MM FOR REFERENCE ONLY