

## DEFFUSER

## FLUDEN

- Used in Return Line
- Reduces Discharge Velocity in Two Stages
- Minimizes Turbulence and Foaming
- Thereby Reduces Aeration / Noise Level
- Must Be Below Oil Level
- Can Eliminate Baffle Plate in Tank
- Consult Factory for Optional Threads



				RATE D			WEIGH T
	PORT			CAPA CITY	A/F		
MODEL	IN. BSP	A	B	LP M	C	D	KGS.
FD4 - 050	3/4"	120	63	50	36	15	0.34
FD4 - 100	1"	125	85	100	45	15	0.38
FD4 - 200	1 -1/4"	160	85	200	51	14	0.50
FD4 - 300	1 -1/2"	190	85	300	60	14	0.70
FD4 - 400	2"	190	100	400	70	15	0.80
FD4 - 500	2 - 1/2"	200	150	500	90	25	0.90
FD4 - 600	3"	250	150	600	100	25	1.00

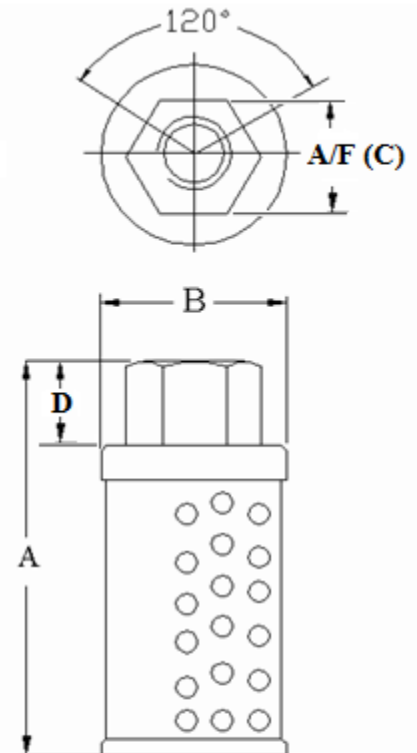

TOLERANCE:  $\pm 1$ MM

SERIES	FLOW	THREAD OPTIONAL
FD4	50	*
	050 - 50 LPM	
	100 - 100 LPM	B - BSP (STD)
FD4	200 - 200 LPM	(OMIT IF NOT REQU.)
	300 - 300 LPM	
	400 - 400 LPM	
	500 - 500 LPM	
	600 - 600 LPM	

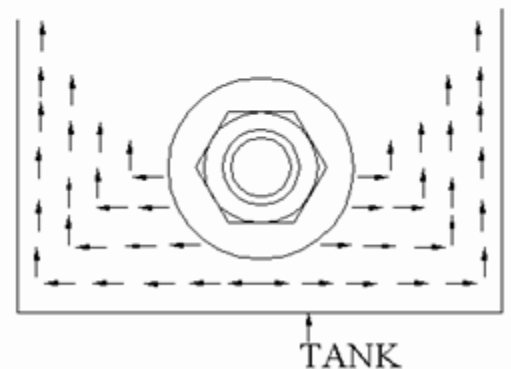

DIMENSIONS IN MM FOR REFERENCE ONLY