

FLUDEN POWER ENGINEERS is a leading metal stamping manufacture of copper flat washers. Washers made from copper are often used within piping, electronics, household products, and biomedical applications as copper is malleable and ductile – a biostatic surface that is a good conductor of heat and, when very pure, a good conductor of electricity.

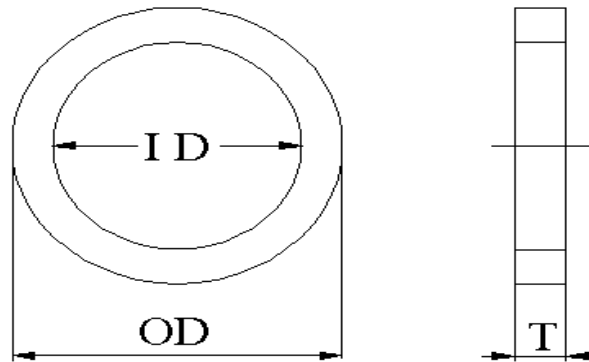

MODEL CODE	SIZE BSP	OUT SIDE DIAMETTER (O D)MM	IN SIDE DIAMETTER (I D)MM	THICKNESS (T)MM
C.W	1/8"	13.5	10	1
C.W	1/4"	18	14	1.5
C.W	3/8"	21	17	1.5
C.W	1/2"	26	21	1.5
C.W	3/4"	32	27	2
C.W	1"	39	33	2
C.W	1-1/4"	48.5	42	2
C.W	1-1/2"	55	48	2
C.W	2"	70	60	2

**TOLARNCE = ± 0.5MM**

**DIMENSIONS IN MM FOR REFERENCE ONLY**